

## CRB10 series relay bases



MRC50mm-1

### Technical data

Type	CRB1051.2	CRB1051.3
Applicable model	CR10	
Rated voltage	300V	
Rated current	12A	
Contact arrangement	2CO	3CO
Accessory	MRC50mm-1	
Dielectric strength adjacent contact circuits	2500	
Protection level	IP20	
Mounting method	panel or 35mm rail	
Conductor cross section solid and stranded	min.0.5mm <sup>2</sup> /max.2.5mm <sup>2</sup>	
Conductor cross section(A.W.G)	min.20/max.14	
Stripping length	7mm	
Screw Thread	M3	
Ambient temperature(operation)	-25 °C to +85 °C	

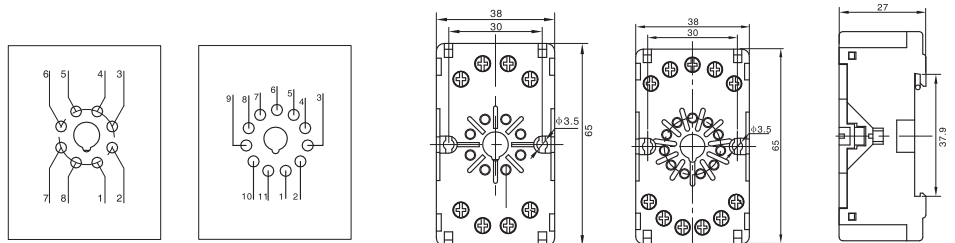

MRC50mm-1



IM1 insert module

### Technical data

Type	CRB1041.2	CRB1041.3
Applicable model	CR10	
Rated voltage	300V	
Rated current	12A	
Contact arrangement	2CO	3CO
Accessory	MR50mm-1 and IM1 insert module	
Dielectric strength adjacent contact circuits	2500	
Protection level	IP20	
Mounting method	panel or 35mm rail	
Conductor cross section solid and stranded	min.0.5mm <sup>2</sup> /max.2.5mm <sup>2</sup>	
Conductor cross section(A.W.G)	min.20/max.14	
Stripping length	7mm	
Screw Thread	M3	
Ambient temperature(operation)	-25 °C to +85 °C	

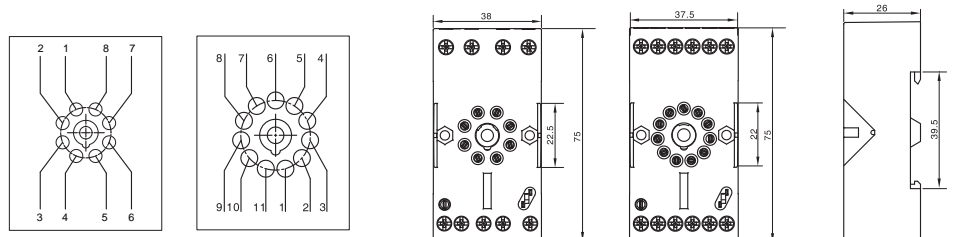



## CRB10 series relay bases



MRC50mm-1

### Technical data

Type	CRB1031.2	CRB1031.3
Applicable model	CR10	
Rated voltage	300V	
Rated current	12A	
Contact arrangement	2CO	3CO
Accessory	MRC50mm-1	
Dielectric strength adjacent contact circuits	2500	
Protection level	IP20	
Mounting method	panel or 35mm rail	
Conductor cross section solid and stranded	min.0.5mm <sup>2</sup> /max.2.5mm <sup>2</sup>	
Conductor cross section(A.W.G)	min.20/max.14	
Stripping length	7mm	
Screw Thread	M3	
Ambient temperature(operation)	-25°C to +85°C	

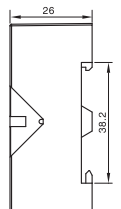
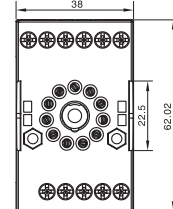
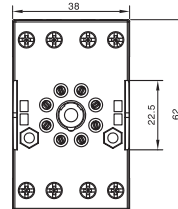
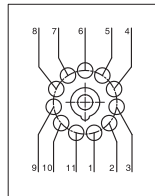
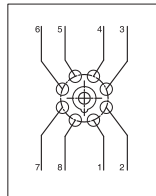

MRC50mm-2

### Technical data

Type	CRB1021.2	CRB1021.3
Applicable model	CR10	
Rated voltage	300V	
Rated current	12A	
Contact arrangement	2CO	3CO
Accessory	MRC50mm-2	
Dielectric strength adjacent contact circuits	2500	
Protection level	IP20	
Mounting method	panel or 35mm rail	
Conductor cross section solid and stranded	min.0.5mm <sup>2</sup> /max.2.5mm <sup>2</sup>	
Conductor cross section(A.W.G)	min.20/max.14	
Stripping length	7mm	
Screw Thread	M3	
Ambient temperature(operation)	-25°C to +85°C	

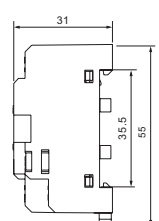
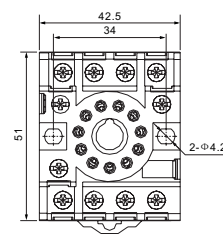
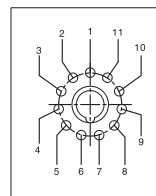
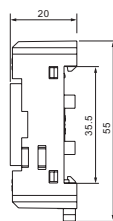
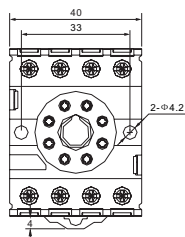
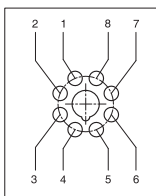

## CRB10 series relay bases



MRC50mm-2

### Technical data

Type	CRB1020.2	CRB1020.3
Applicable model	CR10	
Rated voltage	300V	
Rated current	10A	
Contact arrangement	2CO	3CO
Accessory	MRC50mm-2	
Dielectric strength adjacent contact circuits	2500	
Protection level	---	
Mounting method	panel or 35mm rail	
Conductor cross section solid and stranded	1.5mm <sup>2</sup>	
Conductor cross section(A.W.G)	16	
Stripping length	7mm	
Screw Thread	M3	
Ambient temperature(operation)	-25°C to +85°C	

