



## CRB41 series relay bases

### Technical data

|   |  |
|---|--|
| Type  | CRB4121(detailed type in the table)            |
| Applicable model                              | CR41   |
| Rated voltage                                 | 250V   |
| Rated current                                 | 6A   |
| Contact arrangement                           | 1CO  |
| Accessory                                     | jumper, separator, maker                       |
| Dielectric strength adjacent contact circuits | 2500   |
| Protection level                              | IP20   |
| Mounting method                               | 35mm rail                                      |
| Conductor cross section solid and stranded    | min.1.5mm <sup>2</sup> /max.2.5mm <sup>2</sup> |
| Conductor cross section(A.W.G)                | min.20/max.14                                  |
| Stripping length                              | 7mm  |
| Screw Thread                                  | M2.5   |
| Ambient temperature(operation)                | -40°C to +70°C                                 |



| Type       | Supply Voltage | Coil Input Polarity |
|------------|----------------|---------------------|
| CRB4121.11 | 12-24VAC/DC    | ---                 |
| CRB4121.12 | 48-60VAC/DC    | ---                 |
| CRB4121.13 | 110-125VAC/DC  | ---                 |
| CRB4121.14 | 220-250VAC/DC  | ---                 |
| CRB4121.15 | 6-24VDC        | yes                 |

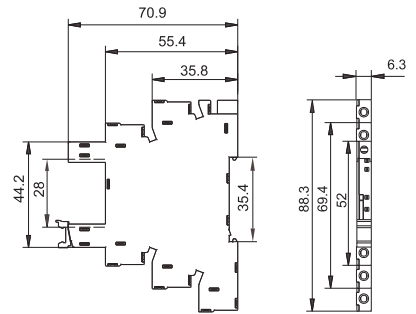
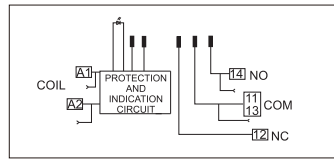

### Technical data

|   |  |
|---|--|
| Type  | CRB4141(detailed type in the table)            |
| Applicable model                              | CR41   |
| Rated voltage                                 | 250V   |
| Rated current                                 | 6A   |
| Contact arrangement                           | 1CO  |
| Accessory                                     | jumper, separator, maker                       |
| Dielectric strength adjacent contact circuits | 2500   |
| Protection level                              | IP20   |
| Mounting method                               | 35mm rail                                      |
| Conductor cross section solid and stranded    | min.1.5mm <sup>2</sup> /max.2.5mm <sup>2</sup> |
| Conductor cross section(A.W.G)                | min.20/max.14                                  |
| Stripping length                              | 7mm  |
| Screw Thread                                  | cage clamp                                     |
| Ambient temperature(operation)                | -40°C to +70°C                                 |



| Type       | Supply Voltage | Coil Input Polarity |
|------------|----------------|---------------------|
| CRB4141.11 | 12-24VAC/DC    | ---                 |
| CRB4141.12 | 48-60VAC/DC    | ---                 |
| CRB4141.13 | 110-125VAC/DC  | ---                 |
| CRB4141.14 | 220-250VAC/DC  | ---                 |
| CRB4141.15 | 6-24VDC        | yes                 |

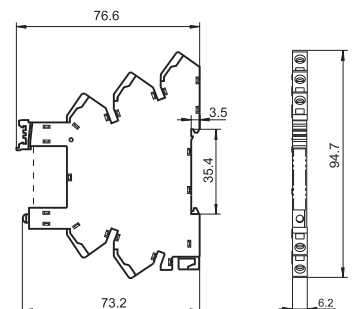
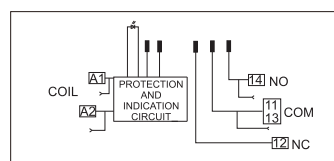

## CRB41 series relay bases



### Technical data

|   |                |
|---|----------------|
| Type  | CRB4103.1      |
| Applicable model                              | CR41           |
| Rated voltage                                 | 250V           |
| Rated current                                 | 6A             |
| Contact arrangement                           | 1CO            |
| Accessory                                     | maker          |
| Dielectric strength adjacent contact circuits | 2500           |
| Protection level                              | ---            |
| Mounting method                               | PCB            |
| Conductor cross section solid and stranded    | ---            |
| Conductor cross section(A.W.G)                | ---            |
| Stripping length                              | ---            |
| Screw Thread                                  | ---            |
| Ambient temperature(operation)                | -40°C to +70°C |

